

Article number: 01 605 06 99

## Exposed shower tap VITUS VD -SC-T /o Mixed water, ThermoProtect thermostat

Manual actuation with automatic closing. Easy flow time adjustment. Shower connection at top.

### Scope of delivery

- Self-closing exposed shower tap
  - SC self-closing button
  - ThermoProtect thermostat, conform to EN 1111, unlockable/lockable temperature lock at 38 °C, anti-scalding protection if cold water supply fails
  - Self-closing cartridge SC II
  - Valve for carrying out manual thermal disinfection (in accordance with DVGW worksheet W 551)
    - 2 backflow preventers (EN 1717: EB-type)
- 2 S-connections and rosettes (depth-adjustable)

### Technical data

- Running time: 5 - 30 s
- Max. operating temperature: 70 °C (80 °C for thermal disinfection)
- Material: Housing Brass, conform to German drinking water regulations
- Surface: Chrome
- Connection: 2x DN 15 G 1/2 AG
- Outlet: DN 15 G 1/2 AG (top)
- Certificates: PA-IX 28574/IB, DVGW, Belgaqua
- Noise class: I
- Flow class: B

### Delivery data

- Weight: 4,04 kg/Piece
- Packing unit: 1

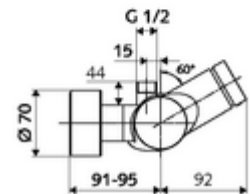
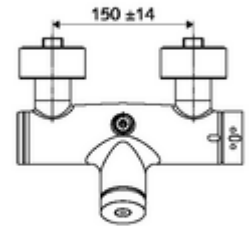
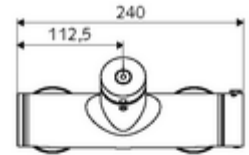

### Recommended associated articles

|                                   |                          |    |
|-----------------------------------|--------------------------|----|
| S-connecting with isolating valve | Article no: 23 775 00 99 |    |
|                                   | Article no: 29 239 00 99 | or |
|                                   | Article no: 29 240 00 99 | or |

#### For concealed shower head connection

|                          |                          |    |
|--------------------------|--------------------------|----|
| Outlet elbow VITUS DN 15 | Article no: 25 667 06 99 | or |
| Outlet elbow VITUS DN 15 | Article no: 25 668 06 99 | or |
| Shower head COMFORT Flex | Article no: 01 821 06 99 | or |
| Low aerosol shower head  | Article no: 01 814 06 99 | or |

#### For exposed shower head connection

|                             |                          |
|-----------------------------|--------------------------|
| Exposed pipe set VITUS      | Article no: 25 666 06 99 |
| Exposed shower head COMFORT | Article no: 01 846 06 99 |