

Article number: 01 315 00 99

Concealed power supply unit 9 VDC, 100 - 240 VAC, 50 - 60 Hz

For supplying power to 1-12 CVD-Touch and/or infrared sensor electronics. Suitable for all SSC- and SWS-capable fittings.

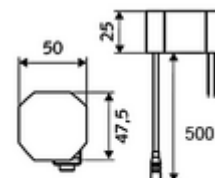

Scope of delivery

- Concealed mains adapter
- Adapter cable

Technical data

- Input: 100 - 240 VAC, 50 - 60 Hz
- Output: 9 VDC, 0.66 A

Delivery data

- Weight: 0,14 kg/Piece
- Packing unit: 1

Necessary associated articles

Universal connection cable 5 m	Article no: 01 570 00 99	or
Universal connection cable 10 m	Article no: 01 571 00 99	or