

Article number: 77 752 00 99

Concealed junction box MONTUS FLOW

For mounting the SWS Bus Extender or SSC Bluetooth modules.

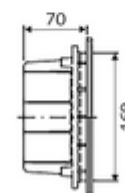
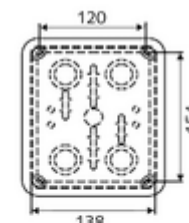

Scope of delivery

- Concealed junction box
 - Cover, 4-way locked
 - Seal for waterproofing on tile or wall

Technical data

- Protection class: IP55

Delivery data

- Weight: 0,51 kg/Piece
- Packing unit: 1

Recommended associated articles

For use with water management system SWS

SWS Bus Extender wired BE-K Flow	Article no: 00 563 00 99	and/or
SWS Bus Extender wireless BE-F Flow	Article no: 00 564 00 99	and/or
SWS Bus extender cable BE-K	Article no: 00 501 00 99	and/or
SWS Bus extender wireless BE-F	Article no: 00 502 00 99	and/or

For operation with Single Control SSC

SSC Bluetooth® module Flow	Article no: 00 929 00 99
----------------------------	--------------------------

In connection with

WC module MONTUS Flow	Article no: 03 038 00 99
-----------------------	--------------------------